



Spectrum Devices Corporation

Semiconductor Engineering and Manufacturing

RF & MICROWAVE TRANSISTORS AVIONICS APPLICATIONS

SD0912-300

FEATURES:

- Refractory/Gold Metallization
- Emitter Site Ballasted
- 15:1 VSWR Capability
- Low Thermal Resistance
- Input/Output Matching
- Metal/Ceramic Hermetic Package
- $P_{out} = 300$ W Min. with 6.3 dB Gain

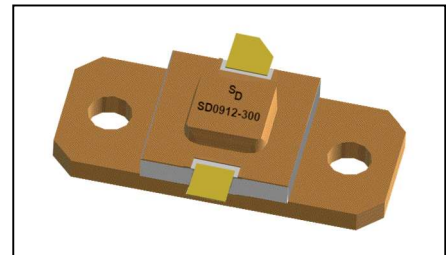

0.4" x 0.4" Hermetic Package

DESCRIPTION:

The SD0912-300 Avionics power transistor is a high peak pulse power device specifically designed for avionics applications requiring broad bandwidth with moderate duty cycle and pulse width constraints such as ground or ship based DME/TACAN.

The SD0912-300 is also designed for specialized applications where reduced power is provided under pulse formats utilizing short pulse widths and high burst or overall duty cycles.

This device is capable of withstanding 15:1 VSWR mismatch load condition at any phase angle under full rated conditions.

The SD0912-300 is housed in a hermetic package with internal input and output matching.

ABSOLUTE MAXIMUM RATINGS (T_{case} = 25°C):

Symbol	Parameter	Value	Unit
P _{DISS}	Power Dissipation* (T _C ≤ 100°C)	940	W
I _C	Device Current*	24	A
V _{CC}	Collector-Supply Voltage*	50	V
T _J	Junction Temperature (Pulsed RF Operation)	250	°C
T _{STG}	Storage Temperature	-65 to	°C

THERMAL DATA:

R _{TH(J-C)}	Junction-Case Thermal Resistance*	0.16	°C/W
----------------------	-----------------------------------	------	------

NOTE: *Applies only to rated RF amplifier operation.

ELECTRICAL SPECIFICATIONS (T_{case} = 25°C)

DC CHARACTERISTICS

Symbol	Test Conditions	Value			Unit
		Min.	Typ.	Max.	
BV _{CB0}	I _C = 10 mA I _E = 0 mA	65	--	--	V
BV _{EB0}	I _E = 5 mA I _C = 0 mA	3.5	--	--	V
BV _{CES}	I _C = 25 mA V _{BE} = 0V	65	--	--	V
ICES	V _{CE} = 50 V	--	--	10	mA
h _{FE}	V _{CE} = 5 V I _C = 300mA	10	--	--	--

RF CHARACTERISTICS

Symbol	Test Conditions	Value			Unit
		Min.	Typ.	Max.	
P _{OUT}	f = 960 – 1215 MHz P _{IN} = 70W V _{CC} = 50 V	300	350	--	W
η _C	f = 960 – 1215 MHz P _{IN} = 70W V _{CC} = 50 V	40	45	--	%
G _P	f = 960 – 1215 MHz P _{IN} = 70W V _{CC} = 50 V	6.3	7.0	--	dB

NOTE: Pulse Format: 10μS
 Duty Cycle: 1%

TYPICAL PERFORMANCE

$V_{CC} = 50V$

Pulse Width = 10 μS , Duty Cycle = 1%

Typical Power Out vs. Power In

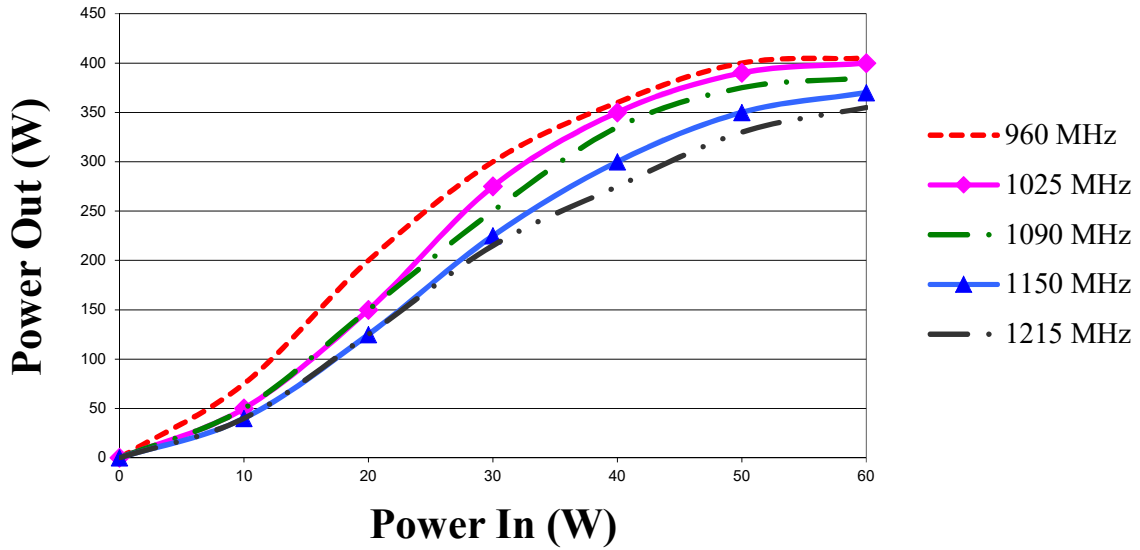

TYPICAL IMPEDANCE DATA

FREQ	Z_{IN} (Ω)	Z_{CL} (Ω)
960 MHz	$2.0 + j3.5$	$1.5 - j2.0$
1090 MHz	$3.5 + j1.5$	$2.0 - j1.5$
1215 MHz	$1.5 + j0.5$	$2.0 - j2.0$

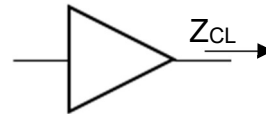
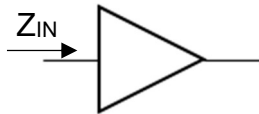

PACKAGE MECHANICAL DATA

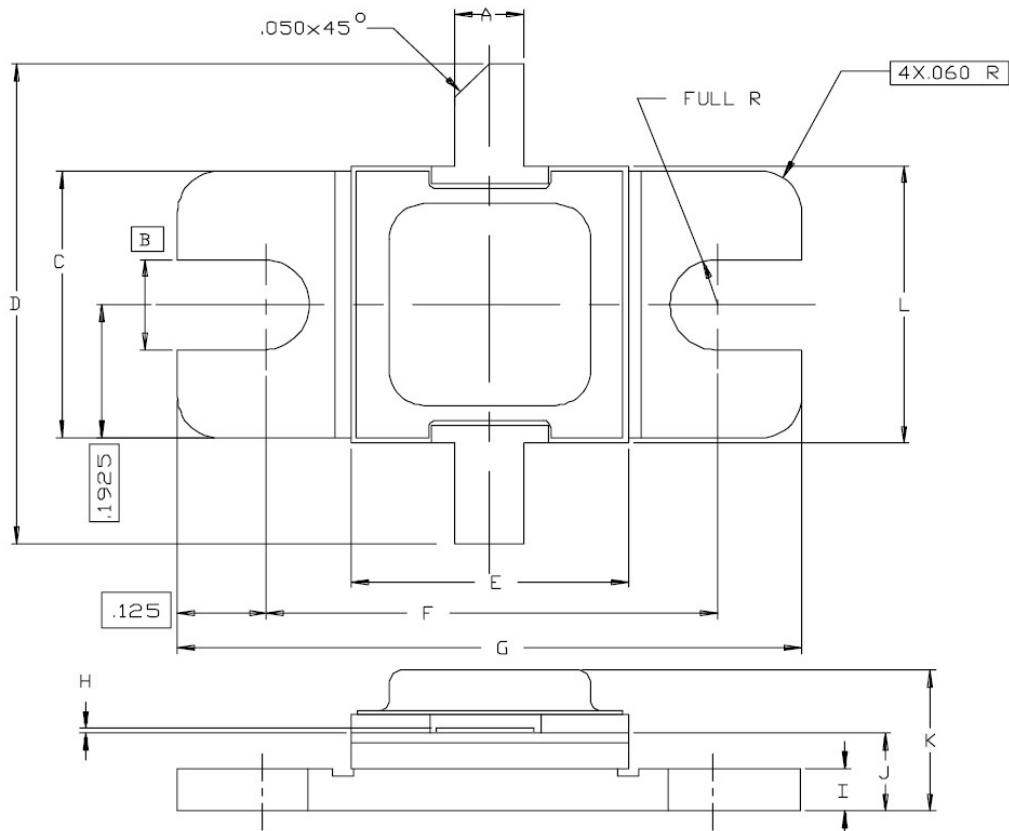

DIM	Inches		mm	
	Min	Max	Min	Max
A	0.095	0.105	2.41	2.67
B	0.130		3.30	
C	0.380	0.390	9.65	9.91
D	0.780		19.81	
E	0.395	0.407	10.03	10.33
F	0.645	0.655	16.26	16.64
G	0.895	0.905	22.73	22.99
H	0.002	0.006	0.05	0.15
I	0.055	0.065	1.40	1.65
J	0.110	0.130	2.79	3.30
K		0.230		5.84
L	0.395	0.407	10.03	10.34

DISCLAIMER

Spectrum Devices Corporation reserves the right to change, without notice, the specifications and information contained herein. Spectrum Devices Corporation believes the information contained within this data sheet to be accurate and reliable. However, no responsibility is assumed by Spectrum Devices Corporation for its use or for any infringement of patents or other rights of third parties which may result from its use. No license is granted by implication or otherwise under any patent or patent rights of Spectrum Devices Corporation. Spectrum Devices Corporation makes no warranty, representation, or guarantee regarding the suitability of its products for any particular purpose. "Typical" parameters are the average values expected by Spectrum Devices Corporation and are provided for information purposes only. These values can and do vary in different applications, and actual performance can vary over time. All operating parameters should be validated by customer's technical personnel for each application.

Life Support Applications

These products are not designed, intended, or authorized for use in applications intended for surgical implant or to support or sustain life, in which the failure of the Spectrum Devices Corporation product could result in personal injury or death. Spectrum Devices Corporation customers using or selling these products in such applications do so at their own risk and agree to indemnify Spectrum Devices Corporation from any damages resulting from improper use or sale.

Visit our website at www.spectrumdevices.com or contact our facility directly at
Spectrum Devices Corp., 3009A Old State Road, Telford, PA 18969.
Phone 215-997-7870